

THE WORLD'S FINEST LUXURY CHARTERS



NEW BEGINNINGS

SUNSEEKER 75 YACHT

'New Beginnings' offers the perfect combination of 'big boat' feel and more compact proportions to ensure great cruising as well as accessibility to smaller ports and anchorages. Sleeping accommodation is spacious and luxuriously appointed. Spaciousness is also the theme in the daytime accommodation – both in the saloon and dining areas and outside in the aft cockpit and on the flybridge. Crew quarters are aft and below decks to ensure maximum privacy.

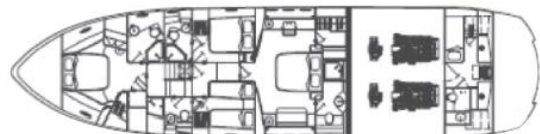
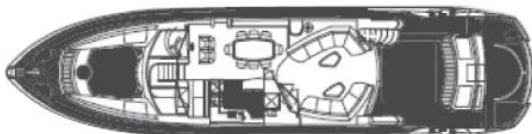

Operating South of France

EUROPEAN SPECIFICATION

NEW BEGINNINGS – SUNSEEKER 75 YACHT

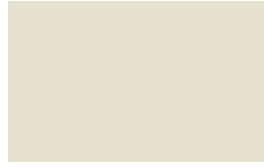
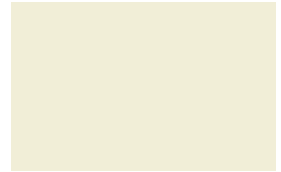

Build to European Specification
MCA coded cat 2
Build date: 2007
Flag: British
Colour: White
Cruising speed: 23 knots
Fuel consumption
@ cruising speed: 350 lph approx
Range @
cruising speed: up to 300 miles
Max speed: 30 knots

Specification
Length overall: 23.13 m 75'9"
Beam (max): 5.66 m 18'6"
Height above waterline: 6.75 m 22'1"
Draft (inc props): 1.68m 5'6"
Displacement @ half load: 42,700 kg 94,140 lb
Fuel capacity: 5,500 ltr 1,210 GB/1,453 US gal
Fresh water capacity: 1,100 ltr 242 GB/291 US gal
Engines: Twin MAN V12 1550hp

Equipment
48" Bose Lifestyle screen in Saloon
DVD/CD Surround system
Flatscreen LCD TV's in all cabins
DVD/CD/MP3 players in all cabins
Satellite TV
Air conditioning
Williams jet tender
Donut and waterskis
Snorkelling gear
Fishing rod

Accommodation
6 Guests in 4 cabins
1 Master aft cabin
1 VIP forward cabin
1 twin port guest cabin
1 double starboard guest cabin
3 Crew
Max 12 guests on day charter plus 3 crew